

SPARTAN HOSPITALITY MENU OF SERVICES

Site Visits

Initial Site Visit \$300

We will measure the interior, photograph, and confirm existing utilities.

Follow-up Site Visit \$300

Re-visit site to establish equipment and fixture layout.
Meet with contractor and or sub contractors to facilitate elec. & plumb. layout.

Design Drawings

Preliminary Conceptual Design \$1000*

Generic equipment plan, seating plan, dimensions of space and any additional fixtures or custom equipment.

Elevation Drawings \$300*

To help visualize equipment or as required by local Health Department.

Dining room/seating plan \$250*

Specified Equipment Schedule \$500*

Specified Equipment Plan \$500*

Kitchen Finish Schedule \$200*

Specifications

Equipment \$475*

Electrical - Kitchen Equipment \$500*

Plumbing - Kitchen Equipment \$500*

Engineered Hood Drawings \$800*

Engineered Walk-In \$375*

Health Dept.

Complete Health Department Conceptual Drawing Set from \$4000*

Includes Preliminary Conceptual Design, Final Conceptual Design, equipment specification, equipment Elec & Plumb specs, seating plan, equipment schedule, and specifications.

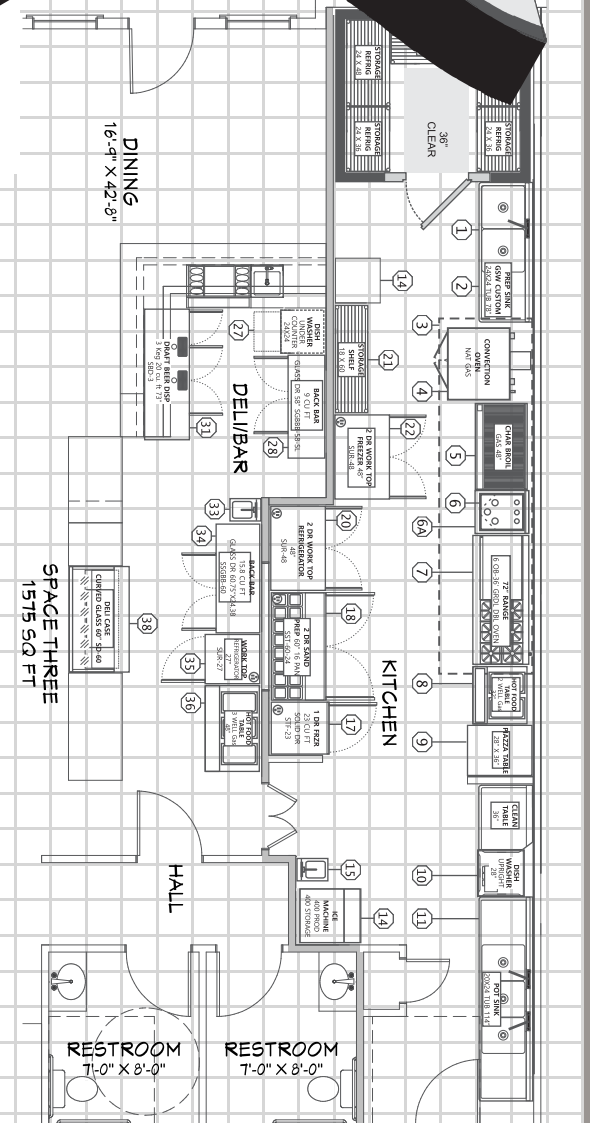

*All prices and items are subject to change without notice and are not guaranteed.

Prices are estimates based on maximum 1500 sq ft space, client supplied architectural drawings, ADA compliant space built to current UBC code.

Spartan Hospitality Services

Spartan Hospitality services consist of those services performed by Spartan Hospitality, its employees, and vendors as selected by Spartan Hospitality.

Spartan Hospitality services include coordination required to integrate all parts of the services.

Preliminary Design Phase

Spartan Hospitality will review information furnished by the Client and review characteristics of the site, including but not limited to dimensional drawing provided by Client, and previously drawn architectural drawings.

Spartan Hospitality will review with the Client alternative approaches to the design of the Project and alternative versions of the floor plan as discussed with Client during consultation.

Spartan Hospitality will review applicable statutes, regulations, codes and by-laws and where necessary review the same with the Authorities Having Jurisdiction. Adhering to all codes, statutes, and or laws will be solely the responsibility of the client.

Spartan Hospitality will prepare and submit to the Client an estimate of probable Preliminary Conceptual Design drawing costs based on Clients review and selection of Spartan Hospitality services.

If after review and acceptance by client, and payment is received, Spartan Hospitality will:

Prepare an initial Preliminary Conceptual Design Drawing. A second and third version of the initial Preliminary Conceptual Design Drawing will be prepared as part of the Preliminary Design Phase. The Preliminary Conceptual Design Drawing will include kitchen/bar equipment floor plan, dry storage, refrigerated storage, ware washing, restrooms (as indicated by Client) and seating/dining areas. Equipment will be shown in generic form with symbols drawn to approximate industry standard size/scale. Any additional drawing not listed will be listed separately on estimate with appropriate costs included.

Final Conceptual Design Drawing Phase

Based on the Client approved Preliminary Conceptual Design Drawings Spartan Hospitality shall:

Prepare, for the Client Final Conceptual Design Drawings to include:

- Floor plan drawings indicating equipment shown in symbol form and represented in a detailed equipment schedule.
- Equipment electrical requirements shown in symbol form and represented in a detailed equipment schedule.
- Equipment plumbing requirements shown in symbol form and represented in a detailed equipment schedule.
- Equipment elevation drawing as required by local Environmental Health Department.
- Finish schedule as per information provided by Client.
- Equipment Specification Sheets for each item listed in the detailed Equipment Schedule.

Spartan Hospitality Additional Services

- Facilitation of project design process utilizing Contractor, architect, and Sub Contractors. Digital plan set distribution, coordination of project meetings either in person at Spartan Hospitality facilities or via Online meeting via web browser application.
- Detailed engineered Walk-in Cooler/Freezer drawings to include electrical, plumbing, and refrigeration specification. Walk-in storage shelving design and specification, and walk-in elevation drawings.
- On site supervision of equipment delivery, uncrate, assemble, and set-in-place. (Subject to approval by Spartan Hospitality).
- Facilitation of equipment installation with Contractor and or Sub Contractors