

SPARTAN HOSPITALITY MENU OF SERVICES

Site Visits

Initial Site Visit \$300

We will measure the interior, photograph, and confirm existing utilities.

Follow-up Site Visit \$300

Re-visit site to establish equipment and fixture layout. Meet with contractor and or sub contractors to facilitate elec. & plumb. layout.

Design Drawings

Preliminary Conceptual Design \$1000*

Generic equipment plan, seating plan, dimensions of space and any additional fixtures or custom equipment.

Elevation Drawings \$300*

To help visualize equipment or as required by local Health Department.

Dining room/seating plan \$250*

Specified Equipment Schedule \$500*

Specified Equipment Plan \$500*

Kitchen Finish Schedule \$200*

Specifications

Equipment \$475*

Electrical - Kitchen Equipment \$500*

Plumbing - Kitchen Equipment \$500*

Engineered Hood Drawings \$800*

Engineered Walk-In \$375*

Health Dept.

Complete Health Department Conceptual Drawing Set from \$2000*

Includes Preliminary Conceptual Design, Final Conceptual Design, equipment specification, equipment Elec & Plumb specs, seating plan, equipment schedule, and specifications.

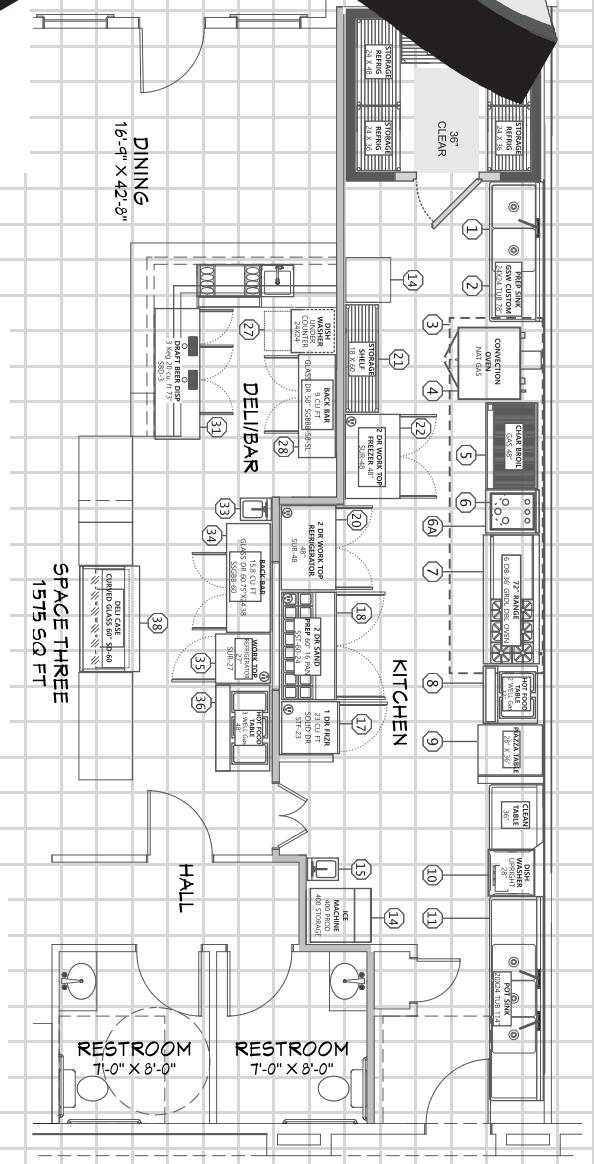

*All prices and items are subject to change without notice and are not guaranteed.

Prices are estimates based on maximum 1500 sq ft space, client supplied architectural drawings, ADA compliant space built to current UBC code.